



**COUNTY OF SAN LUIS OBISPO HEALTH AGENCY
ENVIRONMENTAL HEALTH SERVICES DIVISION**

2156 Sierra Way STE. B, San Luis Obispo, CA 93401
Phone: (805) 781-5544 Fax: (805)781-4211
Email: ehs@co.slo.ca.us



CMFO Example Application
Unpackaged Food/Potentially Hazardous Food (PHF)

EXAMPLE PLAN WITH REQUIRED 3 COMPARTMENT SINK

LIST OF MENU/ITEMS BEING SOLD
<i>Espresso, Lattes, Acai Bowl, Fruit Smoothies, Prepackaged Nutrition Bars, and Whole Fruit</i>

FINISH MATERIALS

*Raw wood not permitted to be used as exterior CMFO material

LOCATION/EQUIPMENT	MATERIAL
Exterior of CMFO	<i>Stainless Steel</i>
Interior of CMFO	<i>Stainless Steel/ Fiberglass Reinforced Panel (FRP)</i>
Food Storage Area	<i>FRP</i>
Food Preparation Compartment	<i>N/A</i>
Other:	<i>Exterior Vinyl Trim</i>

FOOD SERVICE EQUIPMENT LIST

EQUIPMENT	MANUFACTURER	MODEL
Espresso Machine	<i>Nuova Simonelli</i>	<i>Appia Life Compact2</i>
Blender	<i>Vita Mix</i>	<i>36019-ABAB</i>
Undercounter Refrigerator	<i>Bev-Air</i>	<i>UCR27HC</i>
Coffee Brewer	<i>Bunn</i>	<i>Axiom DV APS</i>
Air Pots	<i>Bunn</i>	<i>32130.000</i>
Acrylic Prepackaged Food Display	<i>Custom</i>	<i>Custom</i>
Ice Bin with 2 Piece Lid	<i>Moli International</i>	<i>BIB-1118-D 13"</i>
Soap Dispenser	<i>San Janmar</i>	<i>S30TBK</i>
Paper Towel Dispenser	<i>Bobrick</i>	<i>B-2620</i>

POWER/GAS PLAN

Select all applicable options and fill in the blanks for each one:

- DC Battery* (Quantity 1)
- AC Battery (Quantity)
- Propane Tank (Pounds ; Quantity)

*Requires Inverter

LEFT SIDE VIEW OF CMFO- Internal View Showing Equipment Placement

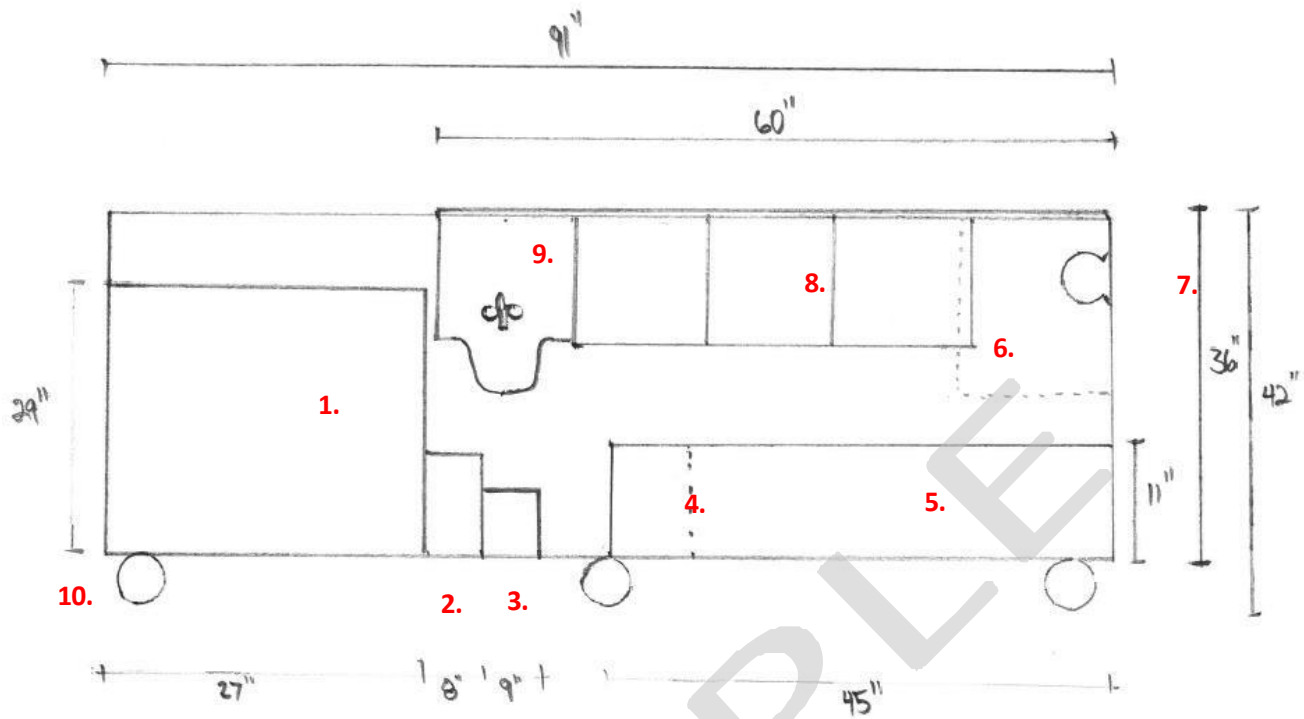

1. Refrigerator
2. Battery, 12V 277 Amps
3. Inverter
4. 40 Gallon Wastewater Tank
5. 20 Gallon Tank Potable Water Tank
6. 6 Gallon Water Heater
7. Water Pump
8. 3-Compartment Sink
9. Handwashing Sink with Soap and Paper Towel Dispenser
10. 6" Swivel Casters

RIGHT SIDE VIEW OF CMFO- Showing Customer Side

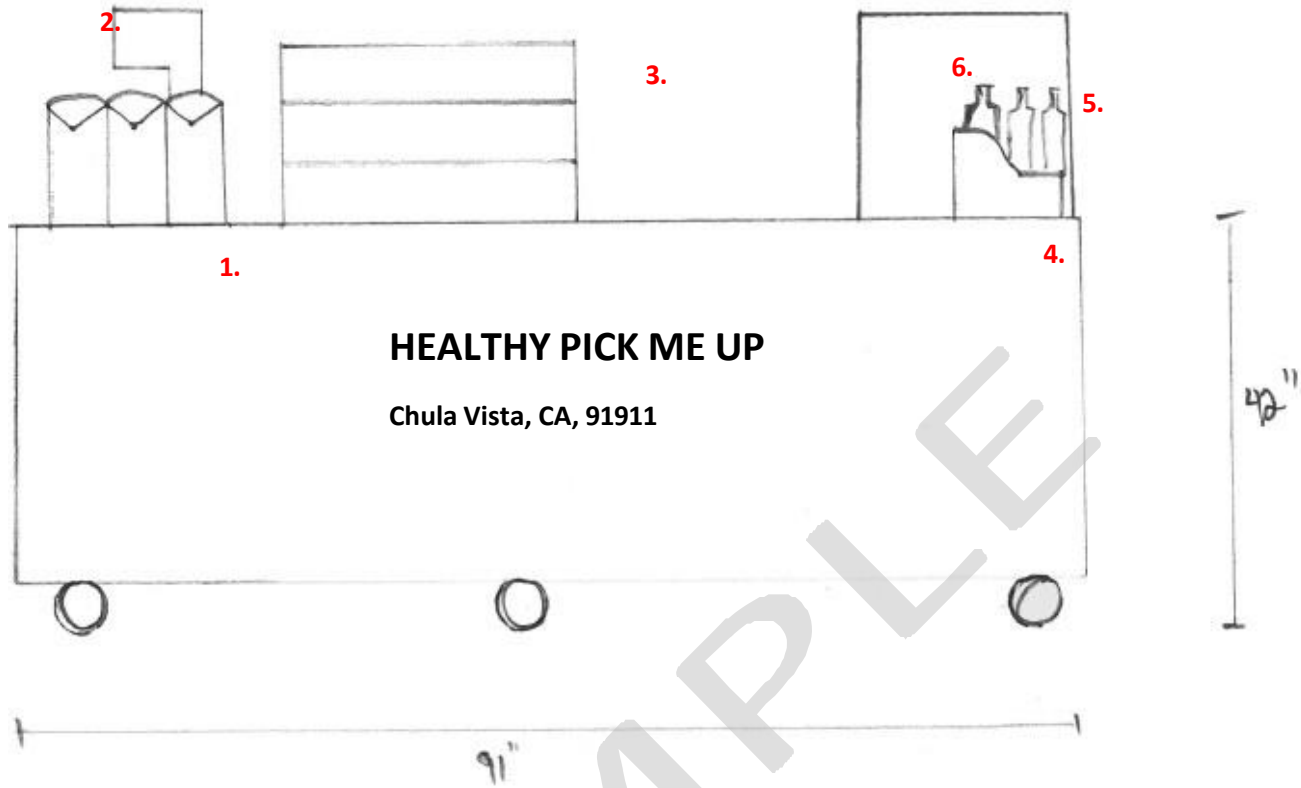

- 1. Airpot Coffee Dispenser
- 2. Coffee Brewer
- 3. Display Shelving
- 4. Point of Sale- Register
- 5. Flavored Syrup with Pumps
- 6. Espresso Machine

***NOTE:** Lettering of the business name: 3" high minimum

City, State, and Zip Code of the permit holder: 1" high minimum

TOP SIDE VIEW OF CMFO

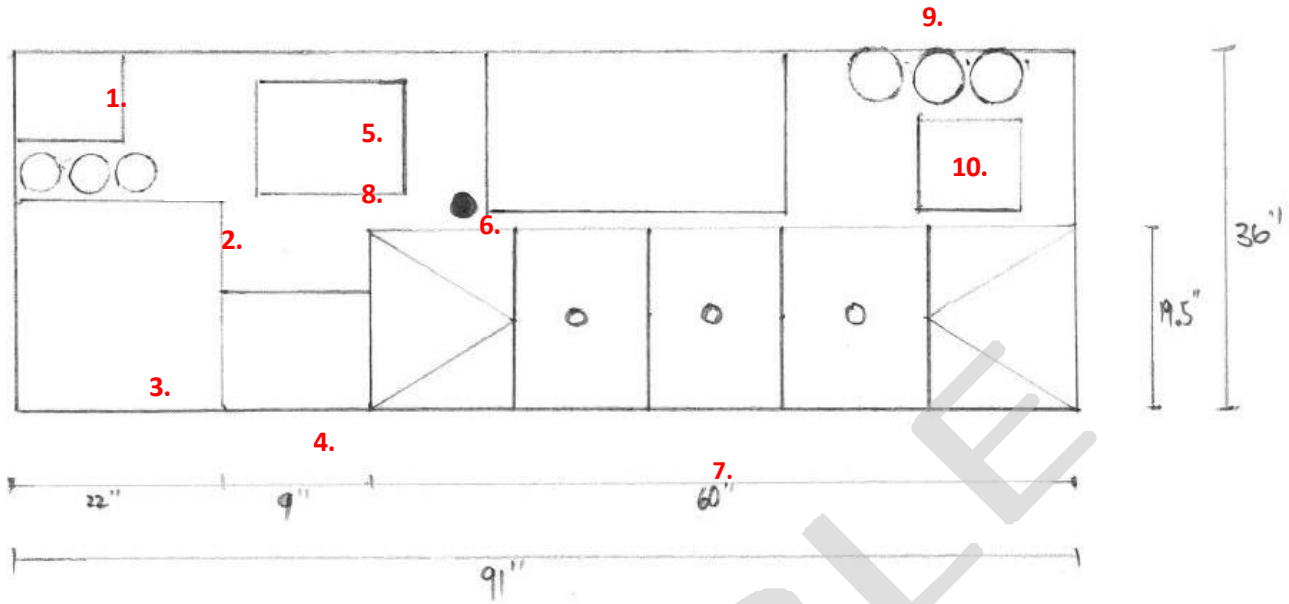

1. Point of Sale - Register
2. Flavored Syrup with Pumps
3. Espresso Machine
4. Blender
5. Ice Bin with 2 Piece Lid
6. Grommet for Umbrella
7. 3-Compartment Sink
8. Display Shelving
9. Airpot Coffee Dispenser
10. Coffee Brewer

LEFT END FROM CUSTOMER SIDE VIEW OF CMFO

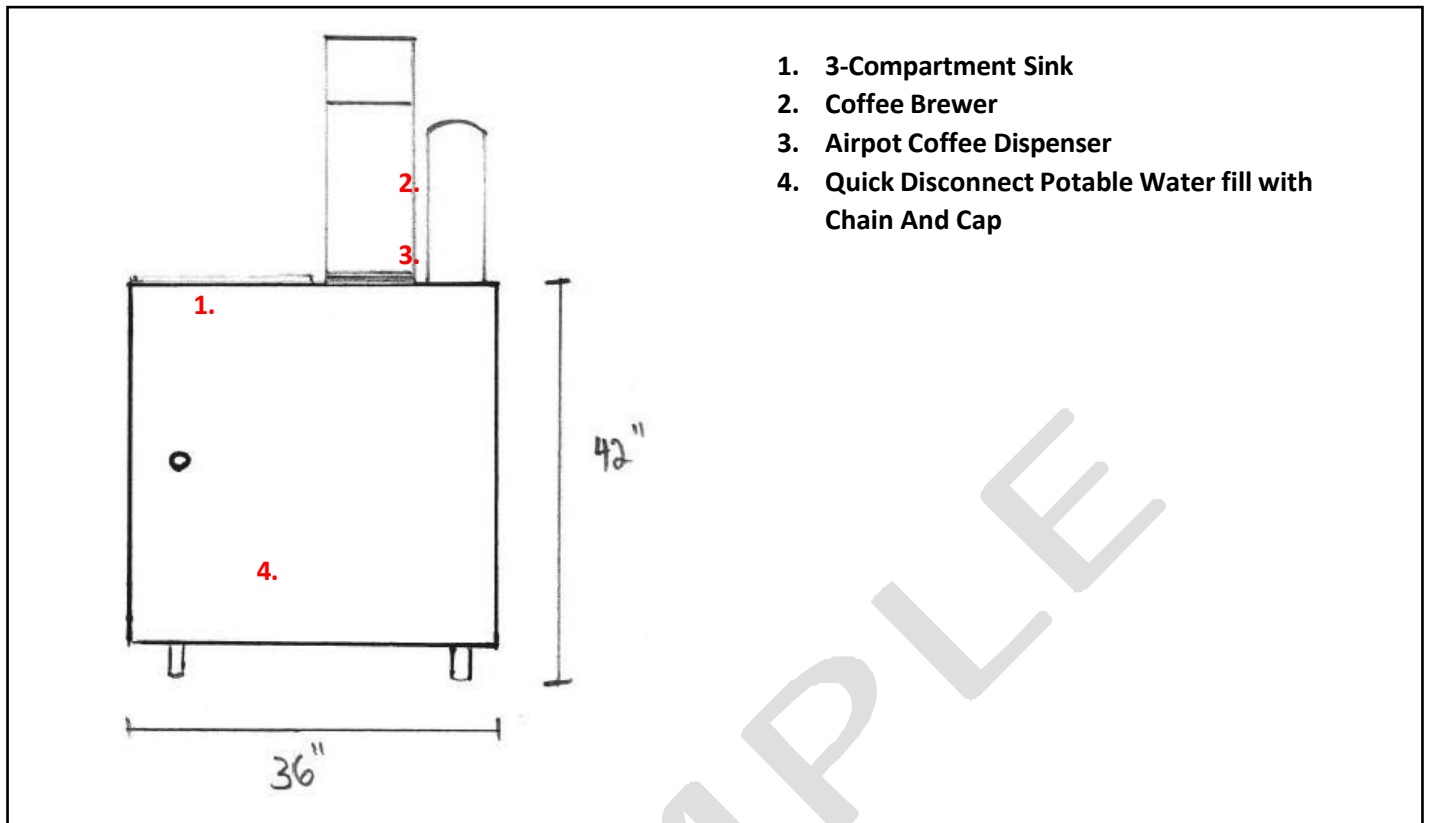

RIGHT END FROM CUSTOMER SIDE VIEW OF CMFO

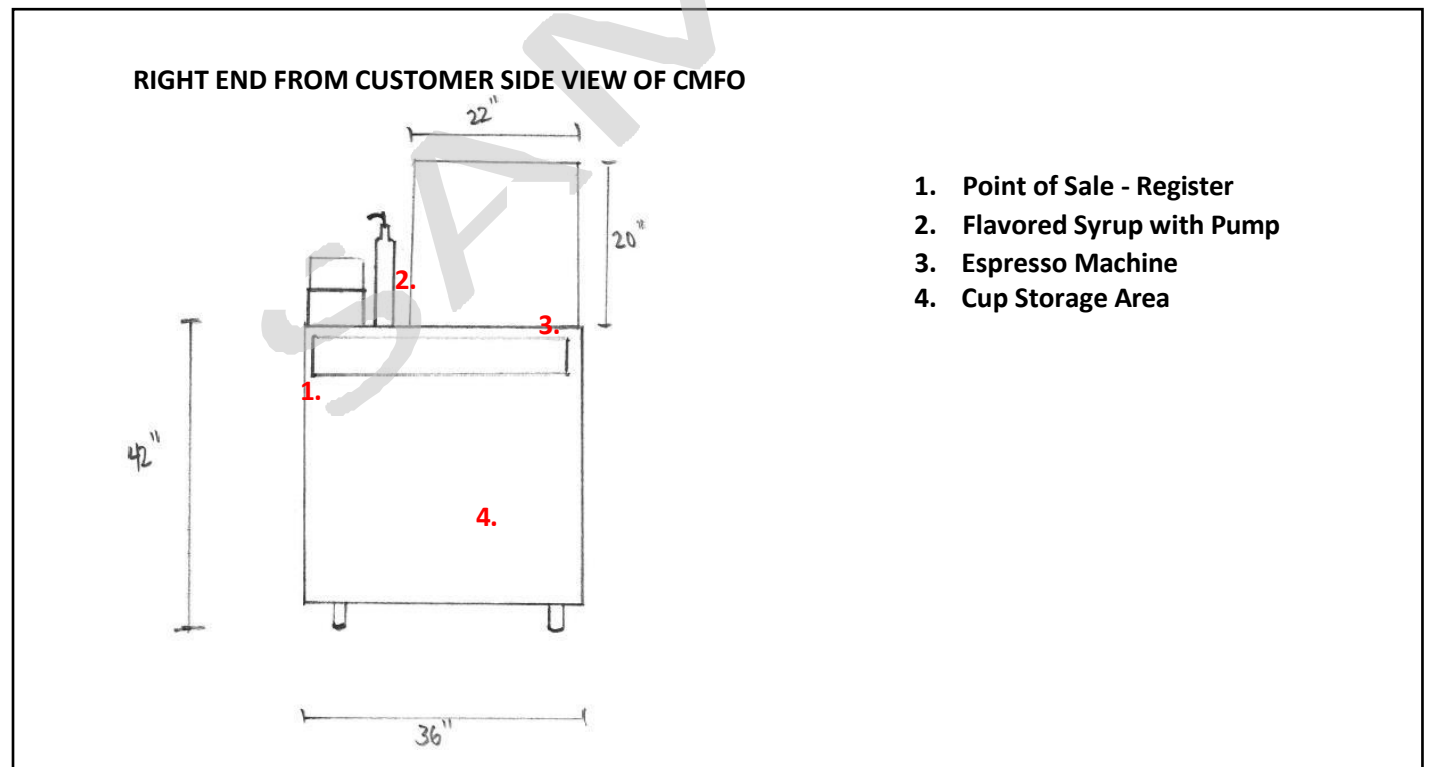

PLUMBING DIAGRAM WITH 3 COMPARTMENT SINK

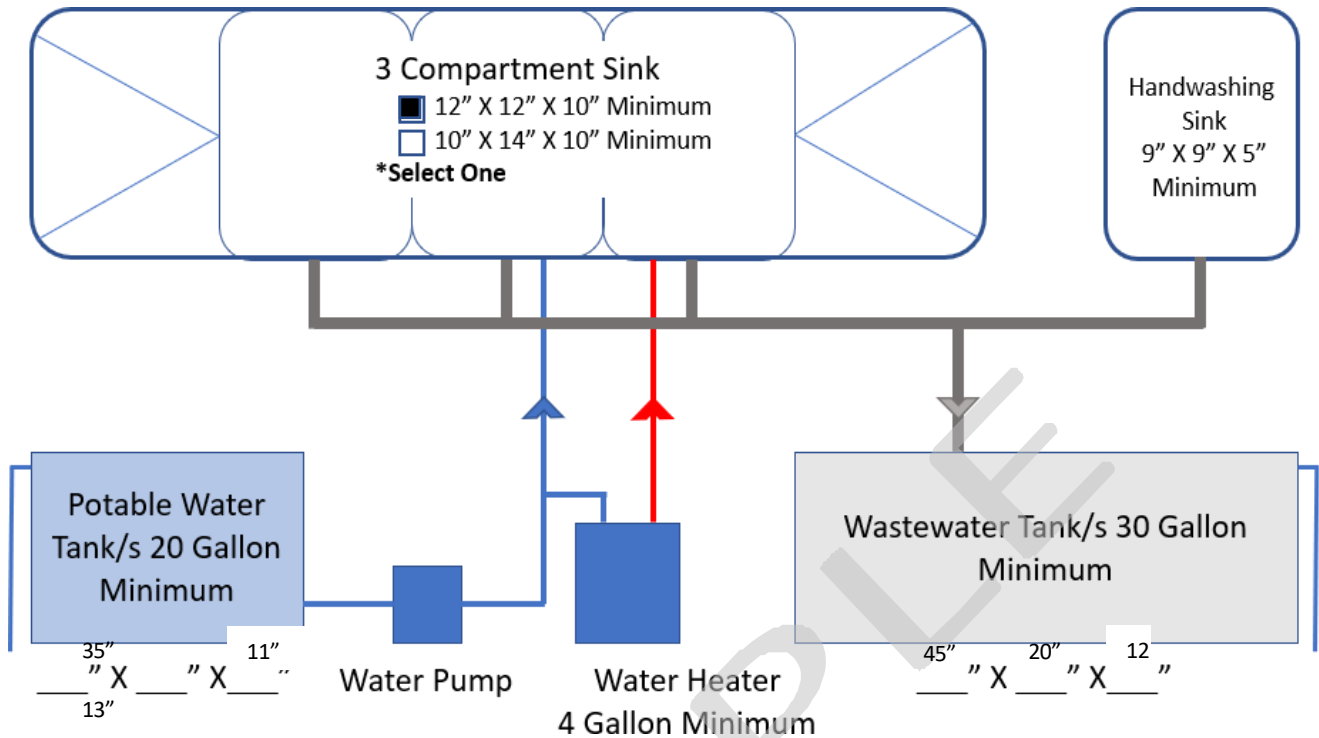

Plumbing Notes:

- All plumbing lines shall be connected to the tanks with watertight seals.
- Potable water lines, couplings, and valves shall be listed to NSF standards for drinking water.
- Potable water tanks and wastewater tanks mounted in the CMFO shall have an air vent overflow installed draining outside of the CMFO in a downward direction covered with 16 mesh per square inch screen.
- Tanks may be removeable. If they are not removeable, they must be equipped with a fill line that has a nonthreaded quick disconnect coupler. They must also be installed sloped towards a drainage outlet equipped with a valve.
- Tanks and hose inlets and outlet fittings shall be protected with a cap and keeper chain, quick disconnect, or closed cabinet when not in use.
- Waste lines must be a different color than the lines for potable water.
- The 3-compartment sink must be stainless steel and equipped with dual integral drainboards that are at least the size of one of the compartments.

WATER PUMP MANUFACTURER AND MODEL: Pentair Shurflo 2088-594-144

WATER HEATER MANUFACTURER AND MODEL: EEMax MiniTank EMT 6

LEFT SIDE VIEW OF CMFO- Internal View Showing Equipment Placement

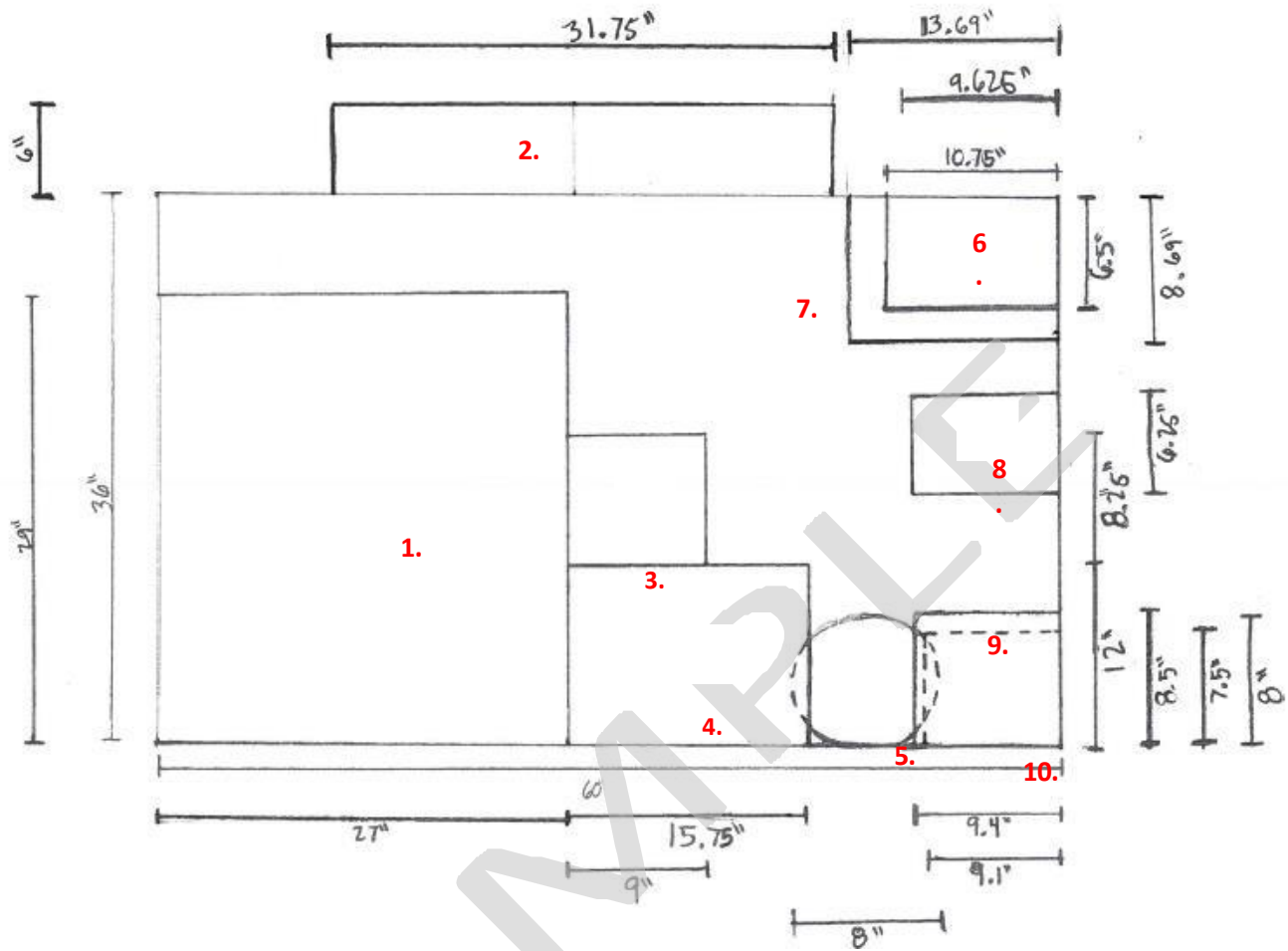

1. Refrigerator
2. Bun Warmer
3. Potable Water Tank
4. Wastewater Tank
5. Water Pump
6. Handwashing Sink with Soap and Paper Towel Dispenser
7. Drop-in Steamer
8. Water Heater
9. Battery 12V, 277Amp
10. Inverter

RIGHT SIDE VIEW OF CMFO- Showing Customer Side

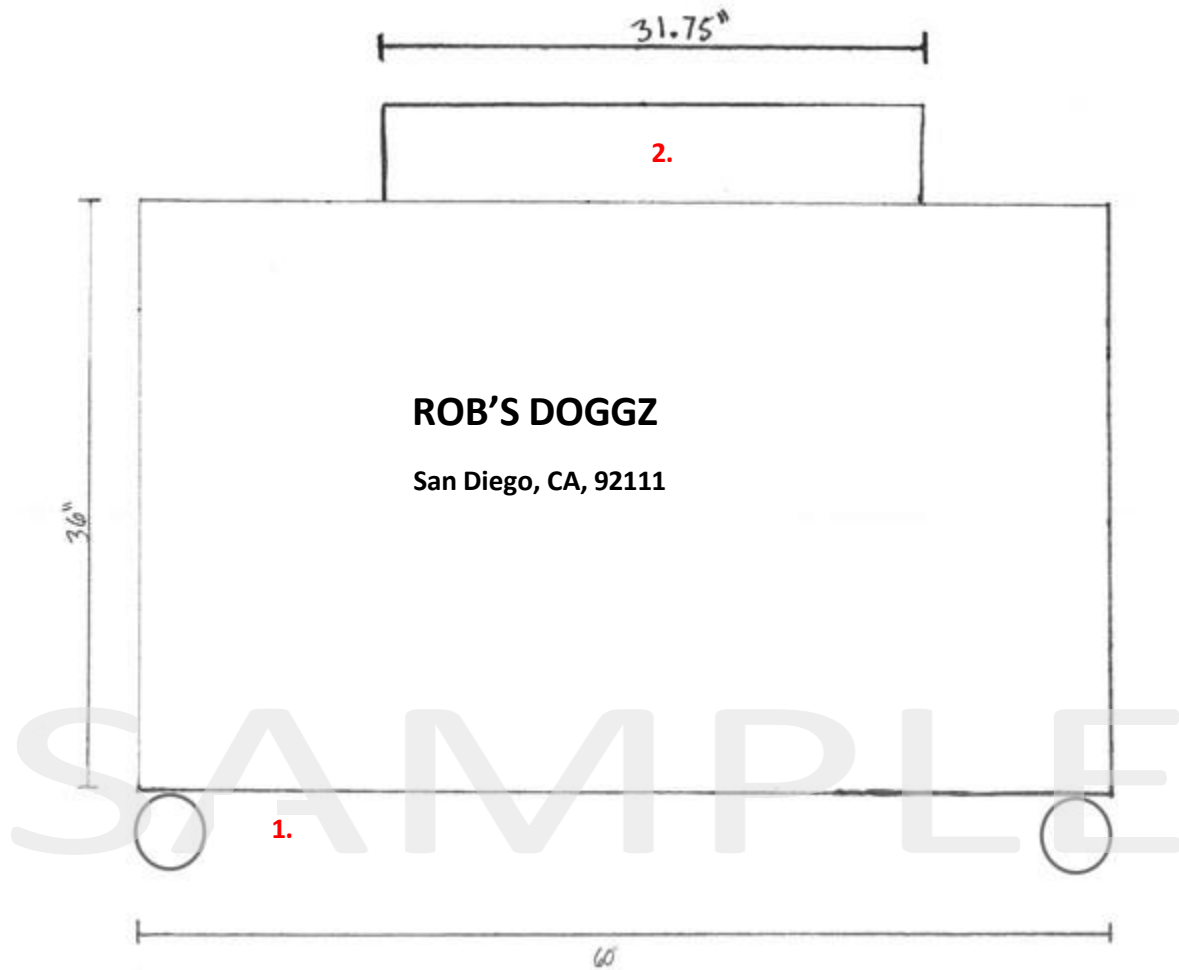

- 1. 6" Swivel Casters
- 2. Bun Warmer

***NOTE:** Lettering of the business name: 3" high minimum

City, State, and Zip Code of the permit holder: 1" high minimum

TOP SIDE VIEW OF CMFO

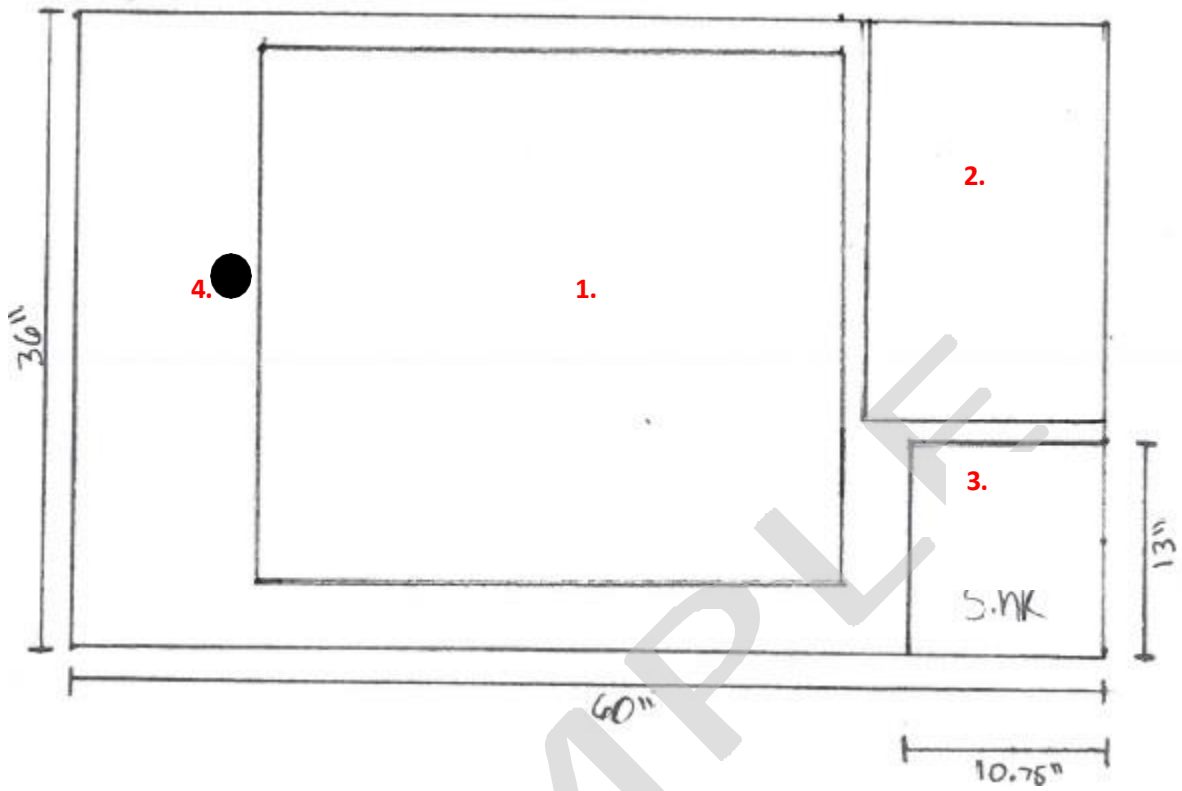

- 1. Bun Warmer
- 2. Drop-in Steam Table
- 3. Handwashing Sink with Soap and Paper Towel Dispenser
- 4. Grommet for Umbrella

LEFT END FROM CUSTOMER SIDE VIEW OF CMFO

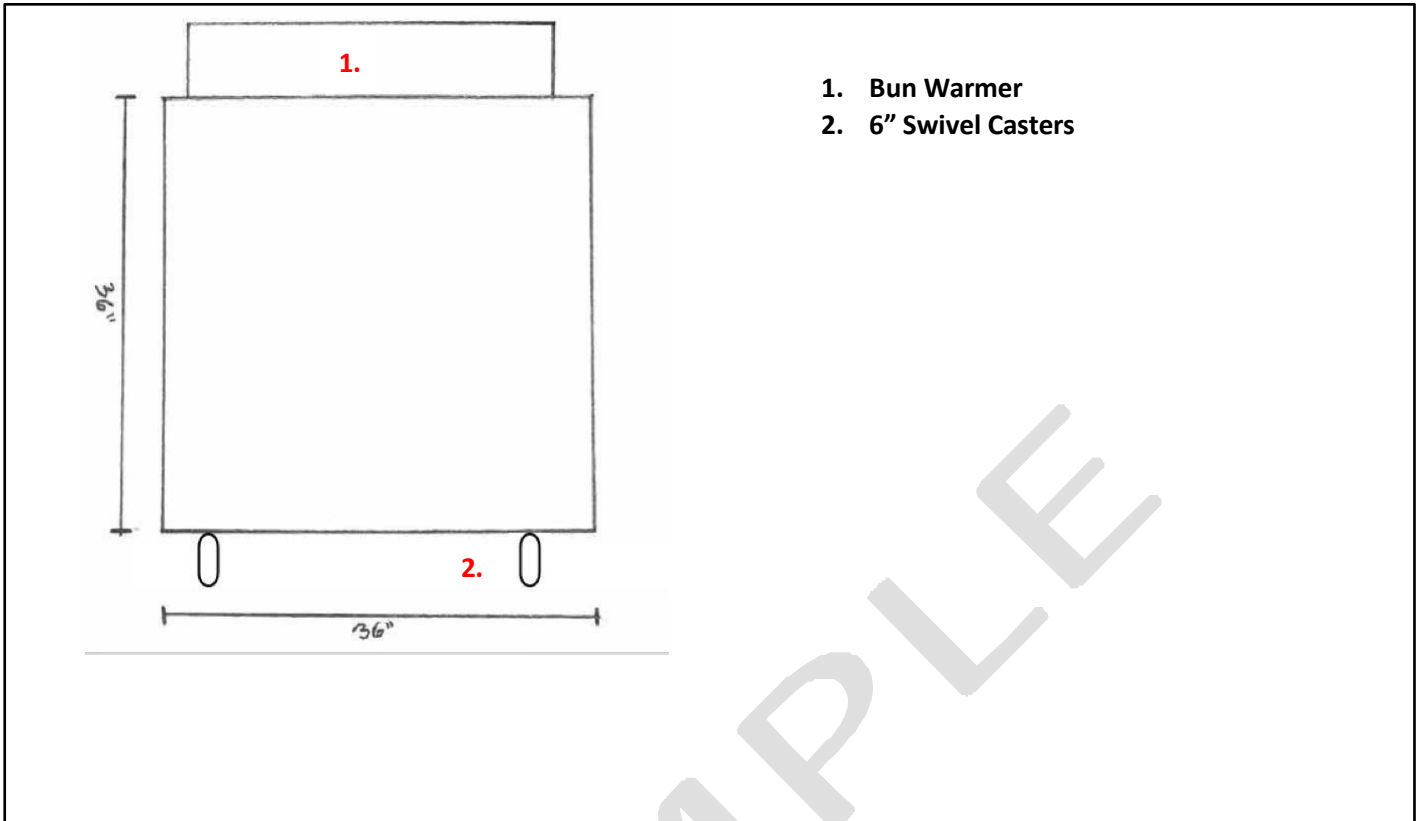

RIGHT END FROM CUSTOMER SIDE VIEW OF CMFO

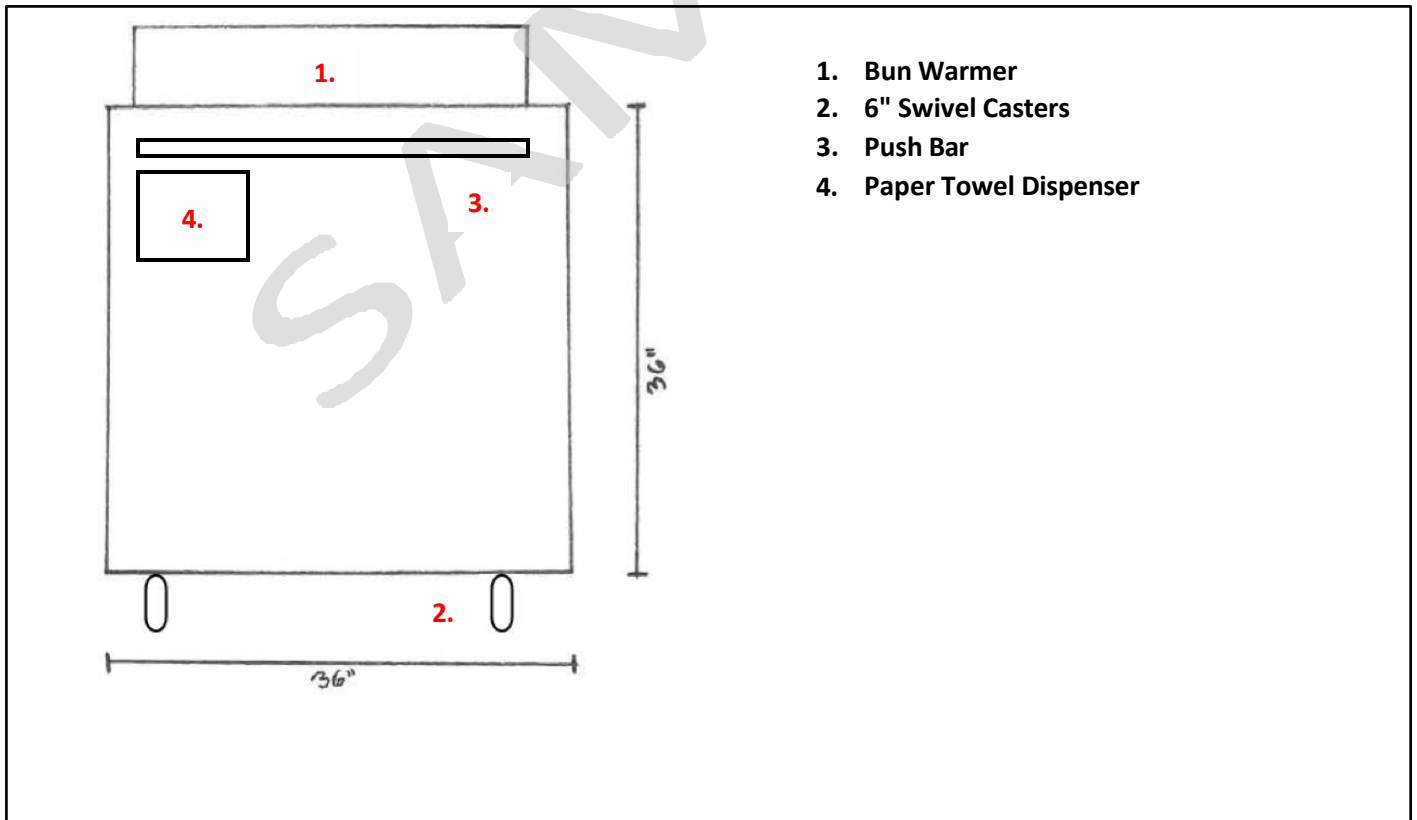

PLUMBING DIAGRAM WITHOUT 3 COMPARTMENT SINK

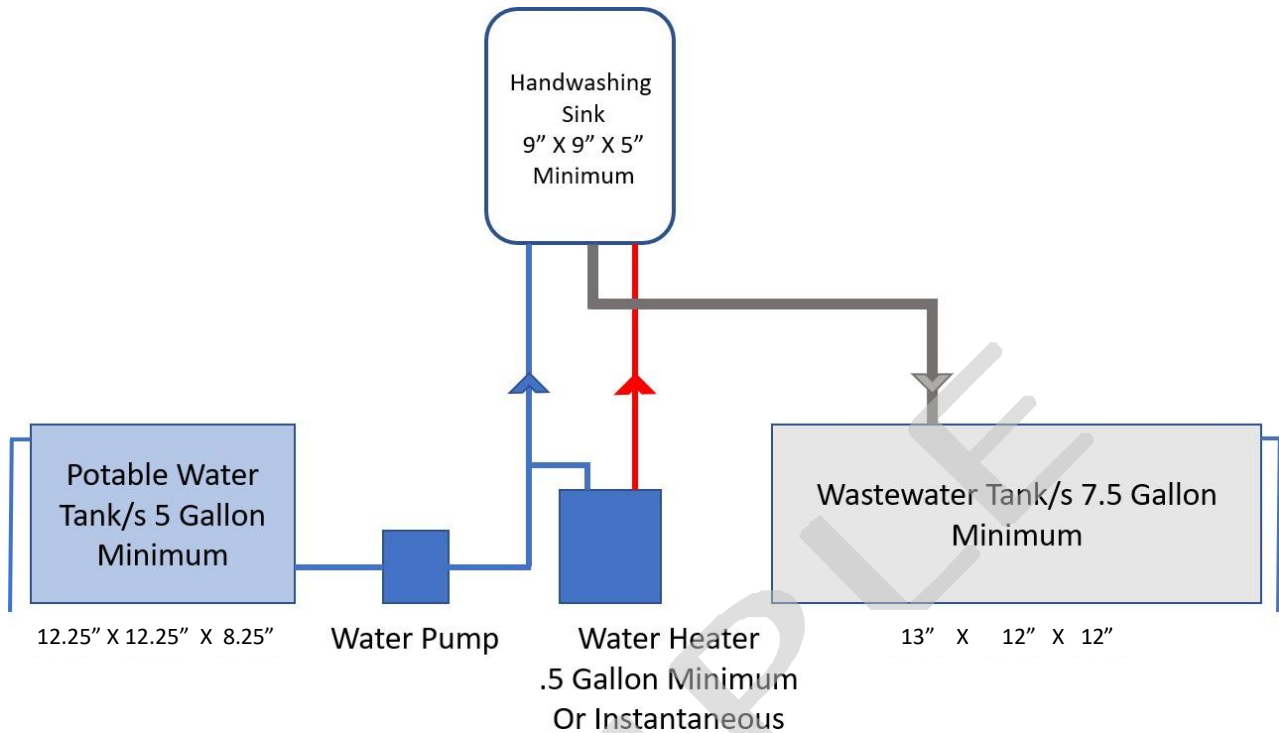

Plumbing Notes:

- Water heater is optional.
- All plumbing lines shall be connected to the tanks with watertight seals.
- Potable water lines, couplings, and valves shall be listed to NSF standards for drinking water.
- Potable water tanks and wastewater tanks mounted in the CMFO shall have an air vent overflow installed draining outside of the CMFO in a downward direction covered with 16 mesh per square inch screen.
- Tanks may be removeable. If they are not removeable, they must be equipped with a fill line that has a nonthreaded quick disconnect coupler. They must also be installed sloped towards a drainage outlet equipped with a valve.
- Tanks and hose inlets and outlet fittings shall be protected with a cap and keeper chain, quick disconnect, or closed cabinet when not in use.
- Waste lines must be a different color than the lines for potable water.

WATER PUMP MANUFACTURER AND MODEL: [Pentair Shurflo 2088-594-144](#)

WATER HEATER MANUFACTURER AND MODEL: [Chronomite Labs SR-20L/120 HTR-I](#)