

FD-
FS.

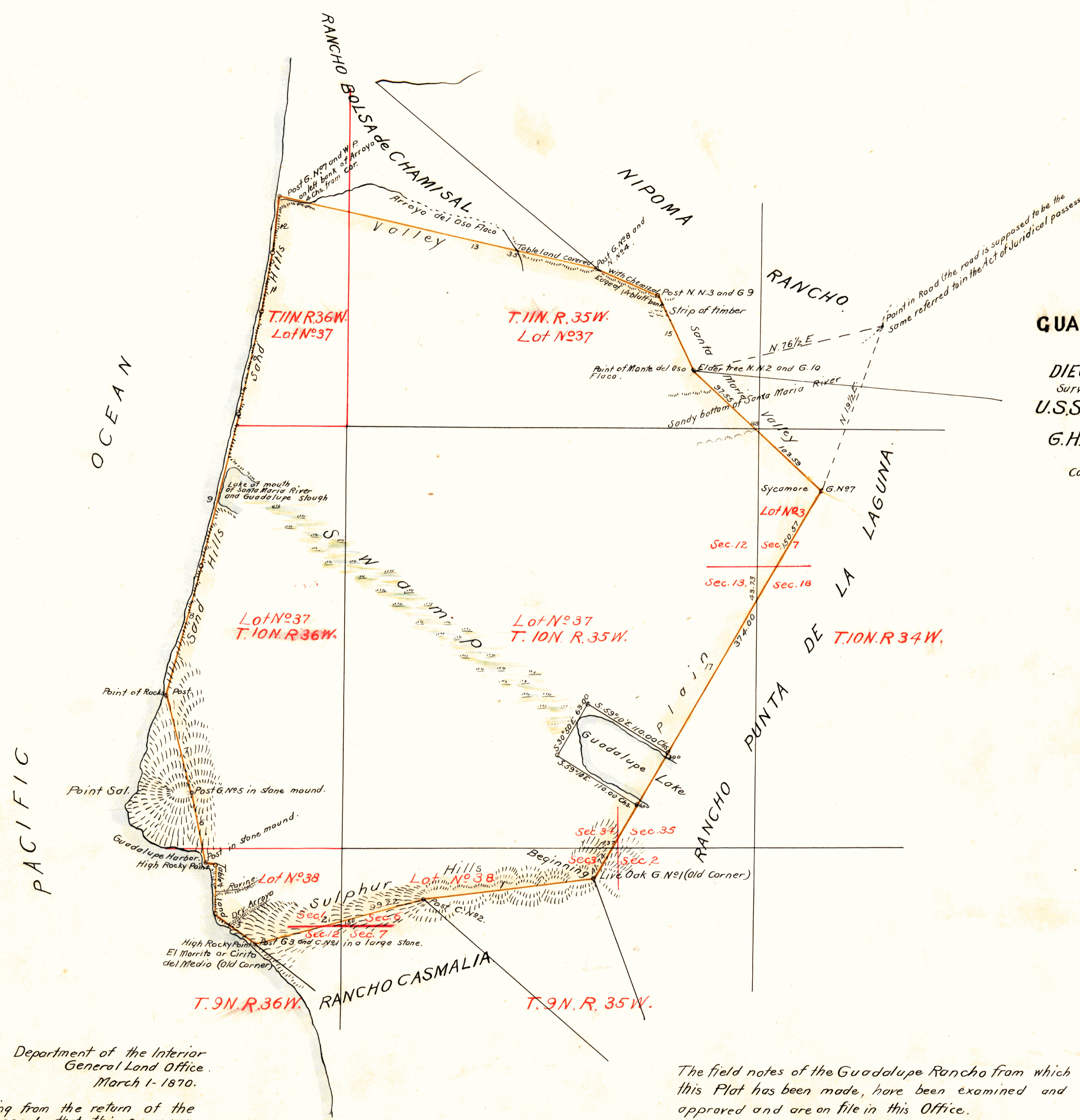

PLAT
of the
GUADALUPE RANCHO
finally confirmed to
DIEGO OLIVERA, et al
Surveyed under instructions from the
U.S. SURVEYOR GENERAL
by
G. H. Thompson, Dep. Sur.
February 1867
Containing 43,681 ⁸²/₁₀₀ Acres
Scale 80 Chs to 1 inch
Variation 14° 30' E.

Boundaries.		
No	Course	Dist
1	S. 83° 7' W.	200.90
2	S. 75° W.	206.00
3	N. 53 1/2° W.	56.00
4	N. 1 1/4° W.	57.58
5	N. 80 1/4° W.	10.74
6	N. 12 1/4° W.	80.97
7	N. 14 3/4° W.	114.52
8	N. 14 1/4° E.	150.00
9	N. 15 1/4° E.	180.00
10	N. 12 1/2° E.	120.00
11	N. 9 3/4° E.	70.00
12	N. 6° E.	64.00
13	S. 77 3/4° E.	382.40
14	S. 66 1/4° E.	80.00
15	S. 26 1/2° E.	95.80
16	S. 48° E.	203.40
17	S. 30° 30' W.	513.78

Department of the Interior
General Land Office.
March 1-1870.

It appearing from the return of the Surveyor General that this survey was advertised for the period and remained without objections in the office of the said Surveyor General for the time stipulated in the act of 1st July 1864. U. S. Statutes, Vol. 13. Page 332 this survey is hereby approved.

Approved March 1-1870
Jos. S. Wilson
Commissioner of the General Land Office.

The field notes of the Guadalupe Rancho from which this Plat has been made, have been examined and approved and are on file in this Office.
U. S. Surveyor General's Office
San Francisco, California.
June 29th 1867.

L. Upson
U. S. Surv. Gen. Cal.

DEPARTMENT OF THE INTERIOR,
GENERAL LAND OFFICE,
Washington, D. C. May 29, 1909.
I hereby certify that this is a true copy of the plat of official survey of the lands to which it relates, on file in this office.

L. Upson
Recorder, General Land Office.

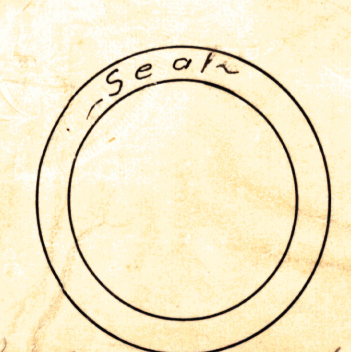

353 B

0 427

Vol N: 47 page 5, #450 502: 4 J